

## Access and store your flat panel monitors in rack-mount frames



Product  
Sheet

MD101, shown at right, allows your monitor to be tilted or rotated for viewing. Below is the MD102, which manages a monitor, keyboard and mouse.



### Ergotron® Monitor Drawer Series

### for 19" Rack-Mount Frames

Securely integrate your flat panel monitor and keyboard into an existing 19" rack-mount frame system. Choose between a drawer for a monitor only (MD101) or our monitor and keyboard drawer (MD102). The MD Series stores your flat panel monitor folded down horizontally, ready to be pulled out for viewing—and it requires only 3U of rack space. These monitor drawers accommodate VESA® FPMPMI™ compliant flat panel monitors; the MD102 handles most keyboards. The MD Series provides a solid platform, even for monitors with touchscreen capability. Cables are safely routed through an integrated cable management system.

#### Features

- MD101 and MD102 require only 3U of vertical height—when monitor is  $\leq 3"$  D and compliant with the VESA® FPMPMI™ standard
- Monitor and keyboard not included—you decide what flat panel monitor and keyboard to use
- MD101 offers 180° of monitor tilt and 360° of rotation for portrait landscape viewing
- Accepts monitors up to 17-1/4" x 16-1/2" x 3" (for MD101) and 17-1/4" x 14-1/2" x 3" (for MD102)
- Solid and stable platform for touch-screen monitor compatibility
- Weight capacity of up to 25 lbs (11.3 kgs)
- Quick and easy 19"-mount installation, mounts to front rails only—does not require attachment to rear rails
- MD102 accepts full-size keyboard for typing in comfort
- Video Electronics Standards Association (VESA®) FPMPMI™ compliant for 75 mm and 100 mm Mounting Interface Standard
- Steel construction for long-lasting durability
- Cables are easily routed through articulating cable channel that keeps them organized and safe
- LIFETIME warranty





Cables are routed through articulating cable channel that keeps them organized and safe.

When not in use, this easy-glide unit is concealed behind its front panel.

The MD102 holds a standard sized keyboard and mouse in the drawer tray.

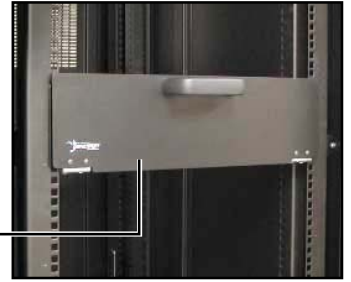

The MD101 allows monitor to tilt 180° up and down and rotate 360° for portrait-landscape adjustment.

Monitor drawers save space and allow for easy access to your equipment.

This unit can be rack mounted at any height, providing maximum ergonomic benefits and minimum space use.

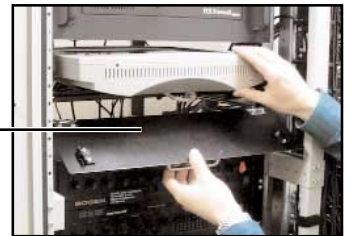
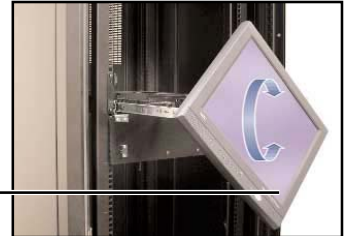

### MD101:

Larger monitors can be rotated into storage position. Requires 3U.

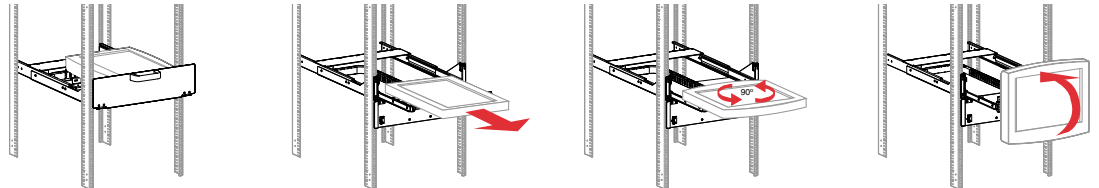
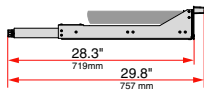

### MD102:

Easy-glide design allows whole unit to fold down into 3U space.

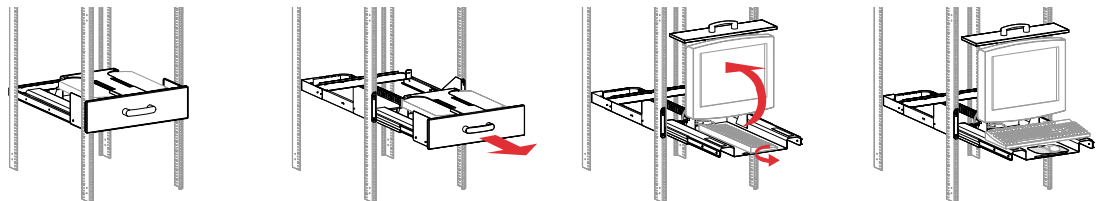
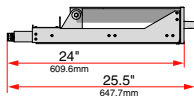

### Basic Specifications:

**Application Options:** Enclosures (≥ 30" ID), 19" rack-mount frames

**Monitor Interface Pad Options:**

- VESA® FPMPI™ 75 mm and 100 mm Interface Plate (Standard)
- Custom Interface Plate (contact Ergotron for details and availability)

**Weight Capacity:** 25 lbs (11.4 kgs)

**Shipping Weight:** MD101 is 14 lbs (6.4 kgs)

MD102 is 25 lbs (11.4 kgs)

**Net Weight:** MD101 is 12 lbs (5.5 kgs) and MD102 is 23 lbs (10.4 kgs)

**Accessory Options:** Mouse Pad, Surge Suppressors and Power Strips

© 2001 Ergotron, Inc.  
rev. 12/03/2001 870-05-037

**Ergotron, Inc.**  
1181 Trapp Road  
St. Paul, MN 55121  
(800) 888-8458  
Fax (651) 681-7717  
www.ergotron.com  
sales@ergotron.com

**Ergotron Europe**  
Hogehilweg 8  
1101 CC Amsterdam ZO  
The Netherlands  
Tel. +31 20 312.29.39  
Fax. +31 20 312.29.40  
info.eu@ergotron.com

